

DIMENSIONS

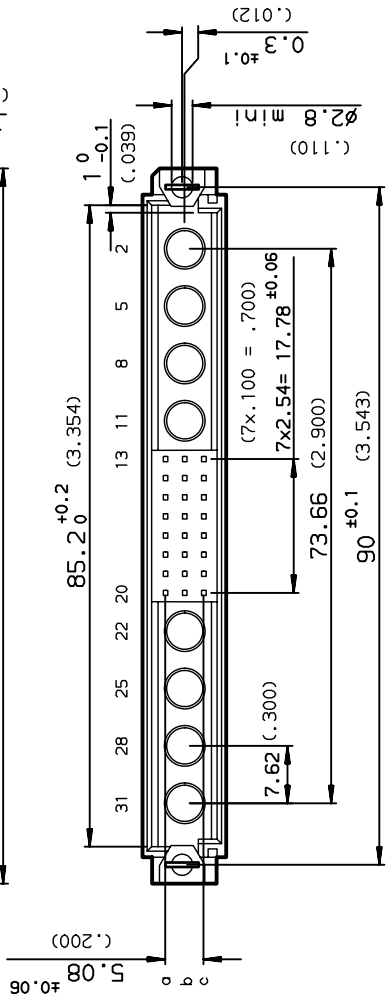

PCB DRILLING

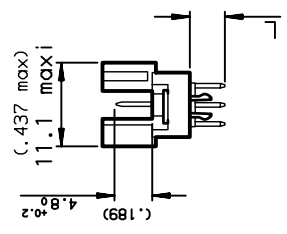
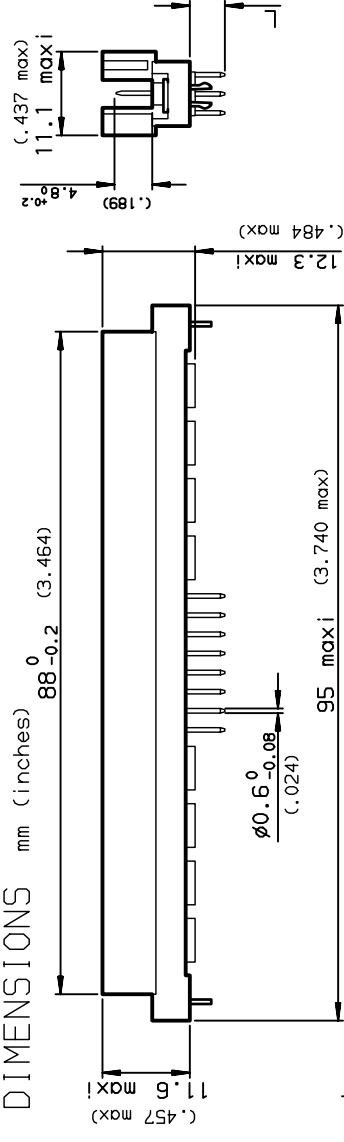
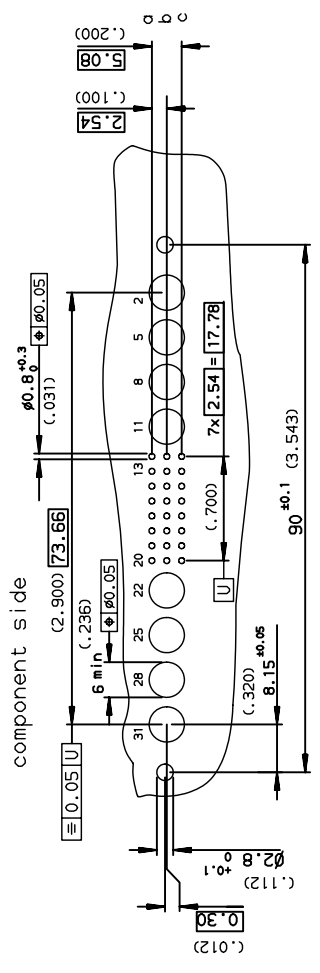

PART NUMBER	8609	G8	5
PIN OUT			
ROWS a-b-c		3	24
ROWS a-c		4	16
NUMBER OF CONTACTS			
TERMINATION			25
L = 17.95 ±0.25 (.706)			24
L = 2.70 ±0.25 (.106)			14
L = 4.65 ±0.25 (.183)			
OPTIONS			7
no option			H
with harpoons			A
- for PCB thickness 1.6 mm			R
- for PCB thickness 2.4 mm			
- for PCB thickness 3.2 mm			
PERFORMANCE CLASS			4
DIN 41612 class 3			5
DIN 41612 class 2			6
DIN 41612 class 1			
TERMINATION TYPE			
TIN LEAD			000E1
LEAD FREE			ETLF

GENERAL CHARACTERISTICS AND ROHS INFORMATIONS:
SEE DRAWING C-8609-0000A

www.fciconnect.com

surface	ISO 1302	tolerance std	ISO 406 ISO 1101	projection	mm
TOLERANCES UNLESS OTHERWISE SPECIFIED		ANGULAR	±0.1	size	A3
		LINEAR	±0.1	ECN	L508-0126
Dr	ROUILLARD	1996/02/22	0.X	Product family	DIN 8609
Eng	TARON	1996/02/22	0.XX	Spec ref	-
Chr	LEGAIRE	1996/02/22	0.XXX		
Appr	LEGAIRE	1996/02/22			

Scale 1.5

European Views

Rev. D

C-8609-0505

SEE TABLE

customer sheet 1 of 1

rev	ech no	dh	date
A	-	-	1996/02/22
B	L505-001	JTA	2005/03/01
C	L506-005	LGO	2006/06/26
D	L508-0126	HLE	2008/05/13
-	-	-	-
-	-	-	-
-	-	-	-